

CO-OP MODEL: C30A

Spec. No. 5000603

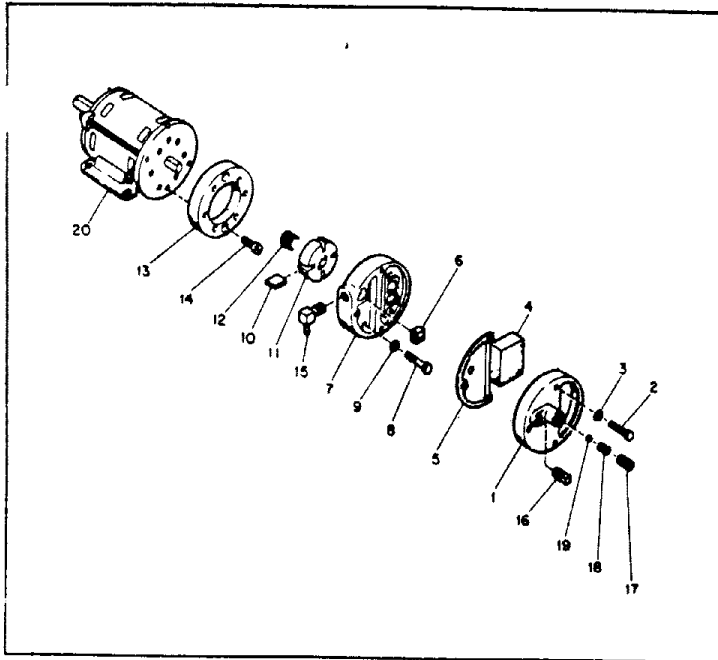

Figure 2. Motor Package Assembly

Key No.	Part Number	Part Name or Description	Qty.
	M29750-01	Motor Package Assembly	1
1	M29609	End Cover, Filter	1
2	M12461-31	Screw (Filter End Cover to Pump End Cover)	3
4	M29633	Intake Air Filter	1
5	M29612-01	Output Filter Assembly	1
6	M29632	Filter, Lint	1
7	M29608	End Cover, Pump (Port Plate)	1
8	M12461-31	Screw (End Cover to Motor) #10-32×1	6
10	M8643	Blade	4
11	M22456-1	Rotor, Pump	1
12	M22009	Insert, Rotor	1
13	M8645	Pump Body	1
14	FHPF3-4C	Screw (Pump Body to Motor) #10-32 × ½	2
15	M50016	Elbow 90°	1
16	M22997	Plug, Socket Hd.	1
17	M27694	Screw, Pressure Adjustment	1
18	M10993-1	Spring, Compression (Pressure Relief)	1
19	M8940	Ball, ¼ in. dia.	1
20	M29780-01	Motor	1

PARTS AVAILABLE — NOT SHOWN

M22898	Decal — Name Plate
M22743	Decal, Warning
M24529	Decal, Tradename
M29800	Decal, Reset
M30728	Decal, Wiring
M20532-5	Decal, Pump Pressure
M31317	Decal, Fuel
M50011	Decal, Spark Plug

