

F-155A HEATER

(7/70)

Fig.& Index No.	Part Number	Part Name	Qty Req.
4- 1	M14244A	Handle, Front	1
	*M12345-34	Screw, Machine, Oval hd, 10-24 x 2 in.	4
	NTC-3C	Nut, Torque lock 10-24	4
2		NOT USED	
	*M11084-27	Screw, Self-Tapping, hex hd. No. 10-32 x 1/2 (Nose Cone to Outer Shell)	4
3	M19805-1B	Shell Assy, Outer	1
	*M11084-27	Screw, Self-tapping, hex hd. No. 10-32 x 1/2 (Outer Shell to tank)	6
	*M10908-27	Screw, Self-tapping, hex hd. No. 10-32 x 1/2 (Outer Shell to Combustion Chamber	4
4	M3364B	Cowl	1
	*M11084-28	Screw, Self-tapping, hex hd. No. 10-12 x 5/8, Type A (Cowl to Outer Shell)	3
	M11271-6	Nut, Tinnerman (Cowl to Outer Shell)	3
5	M17670	Thermostat Assy	1
	*ST1-2BC	Screw, Rd. Hd., No. 6-18 x 1/4 in. (Thermostat)	2
6	M15814B	Bracket, Thermostat	1
	*M11084-27	Screw, Self-tapping, hex hd. No. 10-12 x 1/2	2
7	M9758G6	Combustion Chamber Assy	1
8	M9107G1	Burner Head Assy	1
9	*RC1-2	Screw, Rd.Hd.No. 6-32 x 1/4	2
10	M9108	Nozzle	1
11	M4274	Nozzle Spring	1
12	M3978	Air Deflector	1
13	*HF3-3	Screw, Hex hd., No.10-32x3/8	2
14	M16712	Electrode Bushing	2
15	M10947	Body, Burner	1
16	M3981	Electrode	2
17	M2294	Elbow Compression, 90°	1
18	*M12461-16	Screw Hex hd.No. 8-32 x 5/8	2
19	M9928	Fan	1
20	M18025	Key, Fan Locating	1
21	M3247	Fan Guard Assembly	1
22	REF	Motor and Pump Assy (See figure 4)	1
	*HC4-6C	Screw, Hex hd., 1/4-20 x 3/4	4
	*NTC-4	Nut, Torque Lock 1/4-20	4
	1001349	Connector, Straight (Solenoid Leads)	1
23	M19836	Fuel Line	2
23A	1000577	Grommet (Fuel line to shell)	1

Fig.& Index No.	Part Number	Part Name	Qty Req.
4- 24	M19809A	Handle, Rear	1
	*M12345-34	Screw, Oval hd. 10-24 x 2	4
	*M12345-31	Screw, Oval hd. 10-24 x 1-1/4	2
	*NTC-3C	Nut, Torque Lock 10-24	6
	*WP-3C	Washer, Flat	2
25	M19812-1A	Support Bracket Assy	1
26	M19814A	Support Bracket, Top	1
	*HF3-3C	Screw, Hex hd. 10-32 x 3/8	2
	*WLM-3	Lockwasher	2
	*M12461-26	Screw, Hex hd. 10-32 x 3/8	1
	*NTF-3C	Nut, Torque lock 10-32	1
27		NOT USED	
28	M19916-1	Wiring Harness Assy	1
29	M5895	Switch, Thermal	1
	M8152	Spacer, (Thermal switch to burner head)	2
	*M11084-40	Screw, Self-tapping, Hex hd. No. 8-15 x 5/8 in. Type A (Thermal switch to burner head)	2
30	1000576	Grommet (Electrode Leads through shell)	2
31	M10816G36	Lead, Electrode	2
32	M4785	Fin, Deflector	1
	*M11084-38	Screw, Self-tapping Hex hd. No. 8-15 x 3/8, Type A	2
33	M6821	Grommet (Deflector fin)	1
34	M8633-2B	Door, Access	1
	*M11084-40	Screw, Self-tapping, Hex hd. No. 8-15 x 5/8 in.	2
	M11271-5	Nut, Tinnerman	2
35	M5837	Cover, Box	1
36	M6016	Box, Utility	1
	*HF3-4C	Screw, Hex hd. 10-32 x 1/2	2
	*NTF-3C	Nut, Torque Lock 10-32	2
37	M3530	Grommet	5
38	M10813G12	Extension Cord Assy	1
	1001349	Connector, Straight	1
	M13942-4	Connector, Wire	4
39	M3334G10	Fuel Line Assembly	2
39A	M18919-2	Intake tube assy	2
40	M19807A	Bracket, Motor Support	1
41	M19808A	Bracket, Transformer Support	1
	*M12461-52	Screw, Hex hd. No. 10-24x5/8	5
	*WP-3C	Washer, Plain	5
	*NTC-3C	Nut, Torque lock	5
42	M13990	Plug, pipe 1/4 in.	1
43	M16801-2	Axle	1
44	WP-8C	Washer, Flat	2
45	M16741-15	Ring, Retaining	2
4- 46	M19295	Wheel	2
47	M16802	Cap, Hub	2
48	M12831A	Frame, Wheel Support	1
49	M3259-4	Transformer, Lead Alteration	1
	*NPC-4C	Nut, Hex 1/4-20 (Transformer to bracket)	2
	*WLM-4C	Lockwasher (Transformer to bracket)	2
50	M18051	Cap, Filler Neck	1
*Standard hardware, obtainable locally.			
4- 51	M18053	Screen, Filler Neck	1
52	M19801-1A	Fuel Tank Assy	1
	M17071	Decal, Trade name	1
	M19824	Decal, Nameplate	1
	M19825-4	Decal, Model	1
	M9134	Decal, Wiring	1
	M18196	Decal, Mfg. By	1
	M16420	Decal, Caution	1
	M20532-3	Decal, Pump Prime	1
	M3486-5	Tubing, Varnished	1

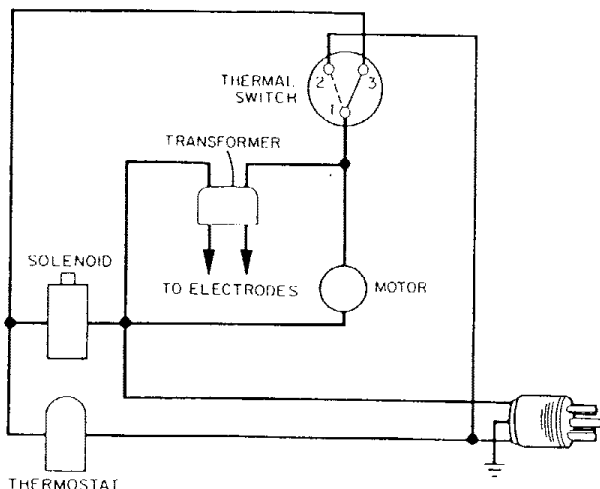

Figure 3. Wiring Diagram

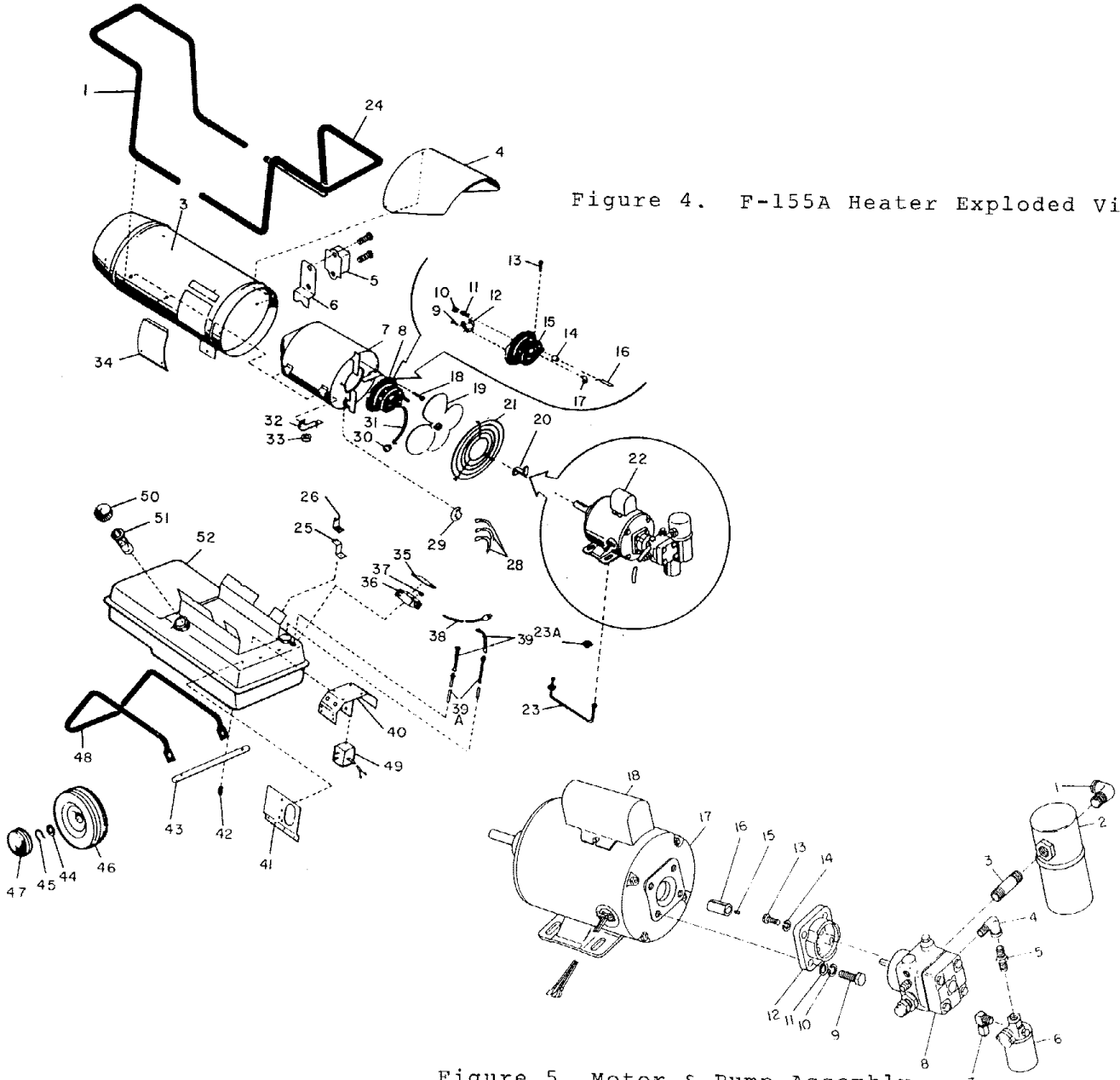

Figure 4. F-155A Heater Exploded View

Figure 5. Motor & Pump Assembly

Fig.& Index No.	Part Number	Part Name	Units Per Assy
5-		Motor and Pump Assy (See 22, figure 4)	N/A
1	57413	Elbow, Street 1/4 in.	1
2	M3973	Filter	1
	M4307	. Filter Can	1
	M3301-2	. Filter Gasket	1
	M3301	. Filter Element	1
3	M20480	Nipple, Pipe, 1/4 x 2-1/2 in.	1
4	57379	Elbow, Street, 1/8 pipe x 1/8 pipe	1
5	69246	Nipple, Hex, 1/8 pipe	1
6	M3974-5	Solenoid Assy	1
7	1000513	Connector, Male	1

Fig.& Index	Part Number	Part Name	Units Per Assy
5- 8	M18364	Pump	1
9	HC5-7C	Screw, Hex Hd, 5/16-18 x 3/4 in.	4
10	WLM-5C	Washer, Lock 5/16 in.	4
11	WP-5C	Washer, Plain 5/16 (Bottom only)	2
12	M18365	Adaptor	1
13	RF3-6	Screw, Round Hd., No. 10-32x3/4 in.	3
14	WLM-3	Washer, Lock, No. 10	3
15	M18436	Spring	1
16	M18366	Coupling	1
17	M9809-2	Motor	1
18	M12650-8	Capacitor	1

N/A - Not available as an assembly. Order individual parts if required.