

Master BV 250 AS

8-72

- 1 M18089A Cone, Nose
- 2 M12461-26 Screw, Hex hd, 10-32 x 3/8 in.
- 3 M11271-6 Nut, Tinnerman
- 4 M23486A Shell, Outer
- 5 M11804-27 Screw, Self-tapping, 10-12 x 1/2
- 6 M11084-27 Screw, Self-tapping, 10-12 x 1/2
- 7 M11242-2A Stack Guard Assembly
- 8 M18087A Cover, Outer shell
- 9 M11084-27 Screw, Self-tapping, 10-12 x 1/2
- 10 M12461-26 Screw, Hex hd, 10-32 x 3/8
- 11 M22905A Support, Cover
- 12 100057G Grommet
- 13 M11271-6 Nut, Tinnerman
- 14 M25118-1 Heat Exchanger Assembly
- 15 M10851A Casting, Exhaust
- 16 M11084-27 Screw, Self-tapping, 10-12 x 1/2
- 17 M4785 Fin, Deflector
- 18 M12461-27 Screw, Hex hd, 10-32 x 1/2
- 19 M11084-27 Screw, Self-tapping, hex hd, No. 10-12 x 1/2
- 20 M10816-33 Electrode Lead Assembly
- 21 M23377 Fan
- 22 M23386-1A Fan Guard Assembly
- 23 M12461-25 Screw, Hex hd, No. 10-32 x 1/4
- 24 WLM-3C Washer, Lock
- 25 M21964 Key, Locating
- 26 Motor and Pump Assembly (See Fig. 6)
- 27 HC4-5C Screw, Hex hd, 1/4-20 x 5/8
- 28 NTC-4C Nut, Torque lock
- 29 M18877 Fuel Line
- 30 M19515A Handle, Rear
- 31 M19516A Handle, Front
- 32 M12345-49 Screw, Oval hd., 10-24 x 2-1/4
- 33 NTC-3C Nut, Torque lock
- 34 M3259-4 Transformer Assembly
- 35 NPC-4C Nut, Plain
- 36 WLM-4C Washer, Lock
- 37 M19513-1A Motor Bracket Assembly
- 38 M11084-27 Screw, Self-tapping, 10-12 x 1/2
- 39 M3334-10 Fuel Line Assembly
- 40 M18919-1 Intake Tube Assembly
- 41 M10813-24 Extension Cord Assembly
- 42 M18774 Axle
- 43 WP-10C Washer
- 44 M8111 Wheel
- 45 C5-10C Pin Cotter
- 46 M18519A Frame, Wheel Support
- 47 M24270 Cover, Terminal strip
- 48 M22012 Control Relay, Safety
- 48A M2030Z Relay, Slave
- 49 M3011 Box, Utility
- 50 M5889 Grommet
- M12461-27 Screw, Hex hd, 10-32 x 1/2
- NPF-3C Nut, Torque lock
- M5187 Connector, Wire
- 1001349 Connector, Straight
- M21962-2 Wire Harness Assembly
- M23297-2 Thermostat Assembly
- M25121A Thermostat Bracket
- M11084-27 Screw, Self-tapping, 10-12 x 1/2
- M21786A Bracket, Box, Mounting
- M8257 Plug, Pipe
- M18053 Screen, Filler
- M23284 Cap, Filler
- M19298-2A Fuel Tank Assembly
- 1001349 Connector, Straight
- M12661A Cover, Box
- M12656-1A Controls and Box Assy
- M12303 Thermostat, Limit
- M12302 Thermostat, Fan
- M12461-18 Screw, Hex hd, 8-32 x 1/8

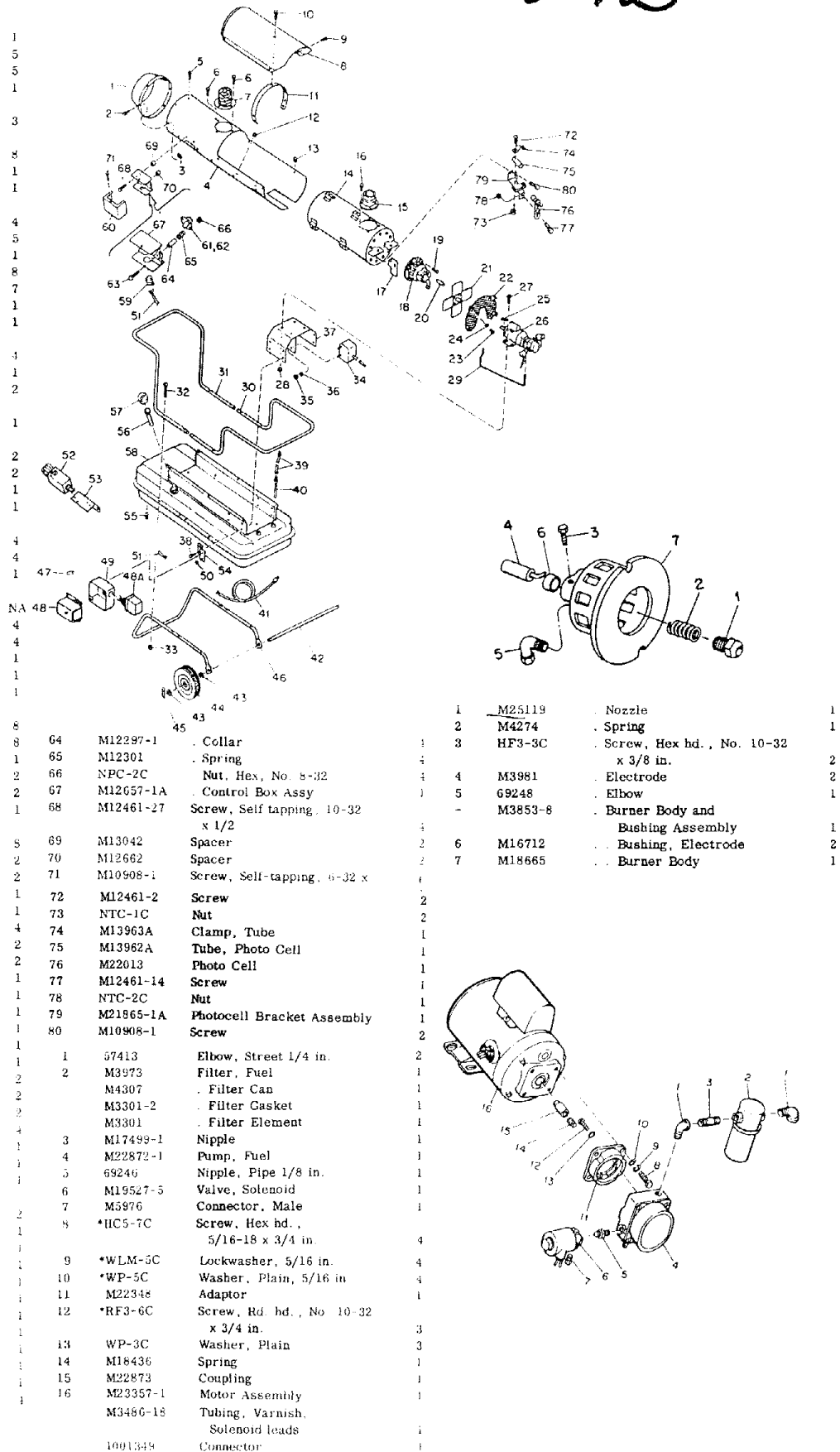

- 64 M12297-1 Collar
- 65 M12301 Spring
- 66 NPC-2C Nut, Hex, No. 5-32
- 67 M12657-1A Control Box Assy
- 68 M12461-27 Screw, Self-tapping, 10-32 x 1/2
- 69 M13042 Spacer
- 70 M12662 Spacer
- 71 M10908-1 Screw, Self-tapping, 6-32 x 1/2
- 72 M12461-2 Screw
- 73 NTC-1C Nut
- 74 M13963A Clamp, Tube
- 75 M13962A Tube, Photo Cell
- 76 M22013 Photo Cell
- 77 M12461-14 Screw
- 78 NTC-2C Nut
- 79 M21865-1A Photocell Bracket Assembly
- 80 M10908-1 Screw
- 1 37413 Elbow, Street 1/4 in.
- 2 M3973 Filter, Fuel
- M4307 Filter Can
- M3301-2 Filter Gasket
- M3301 Filter Element
- M17499-1 Nipple
- M22872-1 Pump, Fuel
- 69246 Nipple, Pipe 1/8 in.
- M19527-5 Valve, Solenoid
- M5976 Connector, Male
- *HCS-7C Screw, Hex hd., 5/16-18 x 3/4 in.
- *WLM-5C Lockwasher, 5/16 in.
- *WP-5C Washer, Plain, 5/16 in
- M22348 Adaptor
- *RF3-6C Screw, Rd. hd., No 10-32 x 3/4 in.
- WP-3C Washer, Plain
- M18436 Spring
- M22873 Coupling
- M23357-1 Motor Assembly
- M3486-18 Tubing, Varnish.
- 1001349 Solenoid leads
- Connector

- 1 M25119 Nozzle
- 2 M4274 Spring
- 3 HF3-3C Screw, Hex hd., No. 10-32 x 3/8 in.
- 4 M3981 Electrode
- 5 69248 Elbow
- M3853-8 Burner Body and Bushing Assembly
- 6 M16712 Bushing, Electrode
- 7 M18665 Burner Body

