

# Model 3E218

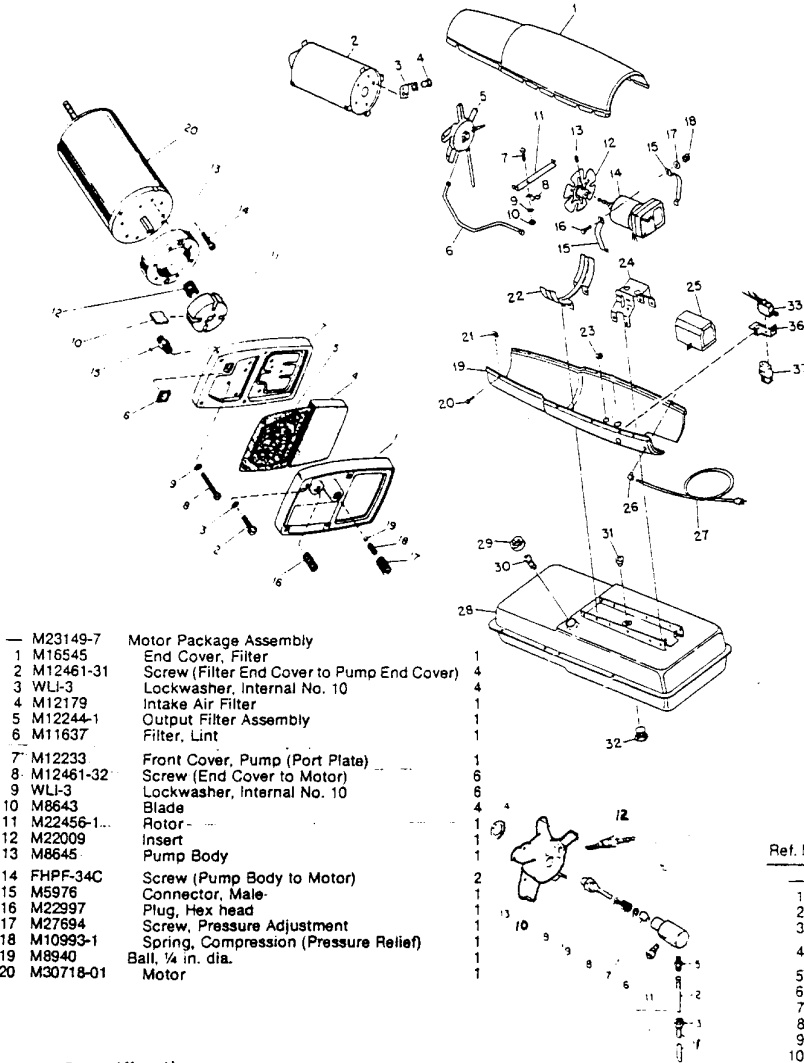

- M23149-7 Motor Package Assembly
- 1 M16545 End Cover, Filter
- 2 M12461-31 Screw (Filter End Cover to Pump End Cover)
- 3 WLI-3 Lockwasher, Internal No. 10
- 4 M12179 Intake Air Filter
- 5 M12244-1 Output Filter Assembly
- 6 M11637 Filter, Lint
- 7 M12233 Front Cover, Pump (Port Plate)
- 8 M12461-32 Screw (End Cover to Motor)
- 9 WLI-3 Lockwasher, Internal No. 10
- 10 M8643 Blade
- 11 M22456-1... Rotor
- 12 M22009 Insert
- 13 M8645 Pump Body
- 14 FHPP-34C Screw (Pump Body to Motor)
- 15 M5976 Connector, Male
- 16 M22997 Plug, Hex head
- 17 M27694 Screw, Pressure Adjustment
- 18 M10993-1 Springs, Compression (Pressure Relief)
- 19 M8940 Ball, 1/4 in. dia.
- 20 M30718-01 Motor

Ref. No.	Part No.	Description	Qty.
1	M13134-3AZ	Shell, Upper	1
	M16781-4	Chamber, Combustion	1
2	M11084-27	Screw (Combustion Chamber attaching front)	2
	M11084-29	Screw (Combustion Chamber attaching rear)	1
3	M16660	Bracket, Photocell	2
	M10908-1	Screw (Photocell Bracket to Combustion Chamber rear head)	2
4	M16655-1	Cell and Bushing Assembly	1
5	M23150-1	Burner Head Assembly (See Figure 11)	1
6	M11084-27	Screw (Burner Head to Combustion Chamber)	3
	M16879	Air Line	1
7	M12461-27	Screw, Slotted Hex Hd., No. 10-32 .1/2"	1
8	M24717	Clamp, Tube	1
9	WLM-3	Lockwasher, No. 10	1
10	NPF-3C	Nut, Plain No. 10-32	1
11	M15807	Strap, Retainer	2
	M11084-27	Screw (Retainer Strap to Lower Shell)	1
12	M23147	Fan	1
13	SF4-2-1-2K	Set screw, Soc. Hd., cup pt., 1/4-20 (Fan to Motor Shaft)	2
14	M23149-7	Motor Package Assembly (See Figure 12)	1
15	M16661	Clamp, Motor	4
16	HC4-10C3	Screw (Motor Clamps)	2
17	WLM-4	Lockwasher, 1/2" (Motor Clamps)	2
18	NPC-4C	Nut, Hex, 1/4-20 (Motor Clamps)	2
19	M15777AZ	Shell, Lower	1
20	M11084-27	Screw (Upper Shell to Lower Shell)	6
21	M11271-6	Nut, Tinnerman (Upper Shell to Lower Shell)	6
	M12330	Bracket, Shell Support	1
22	M11084-27	Screw (Support Bracket to Lower Shell and Fuel Tank)	4
	M11084-29	Screw (Lower Shell to Support Bracket)	2
23	1000576	Grommet (Ignition cable thru Lower shell)	3
24	M25059-02	Bracket, Motor Support	1
	M11084-27	Screw (Motor Support Bracket to Lower Shell and Fuel Tank)	6
25	M16697-02	Transformer, 5000 Volt	1
	M11084-27	Screw (Transformer to Motor Support Bracket)	2
26	M11143-1	Bushing, Strain Relief (Service Cord to Lower Shell)	1
27	M10813-74	Cord Assembly, Extension	1
28	M27552-01AA	Tank Assembly, Fuel	1
29	M23284	Cap, Fuel Tank	1
30	M50323	Screen, Filler neck	1
31	M10990-3	Bushing, Rubber (Fuel Filter into Fuel Tank)	1
32	M27417	Plug, Drain	1
33	M28898-03	Safety Control Assembly	1
36	M25296-1	Bracket, Starting Relay Mounting	1
37	M12462-6	Relay, Starting	1
	RC2-2C	Screw (Starting Relay to Mounting Bracket)	2
	M11084-27	Screw (Grounding)	1
	M11084-27	Screw (Relay Bracket to Shell)	1
	M9900-72	Wire Assembly, Black (To Starting Relay)	1
	M9900-80	Wire Assembly (To Breaker)	1
	M16615-1	Harness Assembly	1
	M13942-5	Connector, Wire	2
	M13942-7	Connector, Wire	3

Ref. No.	Part No.	Description	Qty.
—	M23150-1	Burner Head Assembly	1
1	M15790-8	Filter, Tube	1
2	M19630	Filter, Fuel	1
3	M13849	Nut, Flared	1
4	M16741-18	Ring, Retaining	1
	M23151-1	Nozzle Adapter Assembly	1
5	M16791	Connector, Male	1
6	M5976	Connector, Male	1
7	M8882	Sieve, Nozzle Seal	1
8	M10659-1	Washer, Nozzle Seal	2
9	M10809-1	Spring, Nozzle Seal	1
10	M23103	Nozzle, Aspirating 0.66 GPH	1
11	M16535	Adapter, Nozzle	1
12	M10962-2	Spark Plug	1
13	M16534	Body, Burner Head	1

## Specifications

Output rating (BTU per hour)	90,000
Amperage (during normal run)	4.0
Air pump pressure (PSI)	4
Weight (approx. lbs.)	79
Shipping	79
Dry (net)	62
Fuel tank capacity, U.S. gallons	9.0
Fuel consumption, approx. U.S. gal. per hour	0.66
Electrical requirements	115V, 60Hz
Motor RPM	3,450
Fuel	Kerosene or No. 1 fuel oil <u>ONLY</u>
Duct	No duct recommended

