

OWNER'S MANUAL

PORTABLE SPACE HEATERS

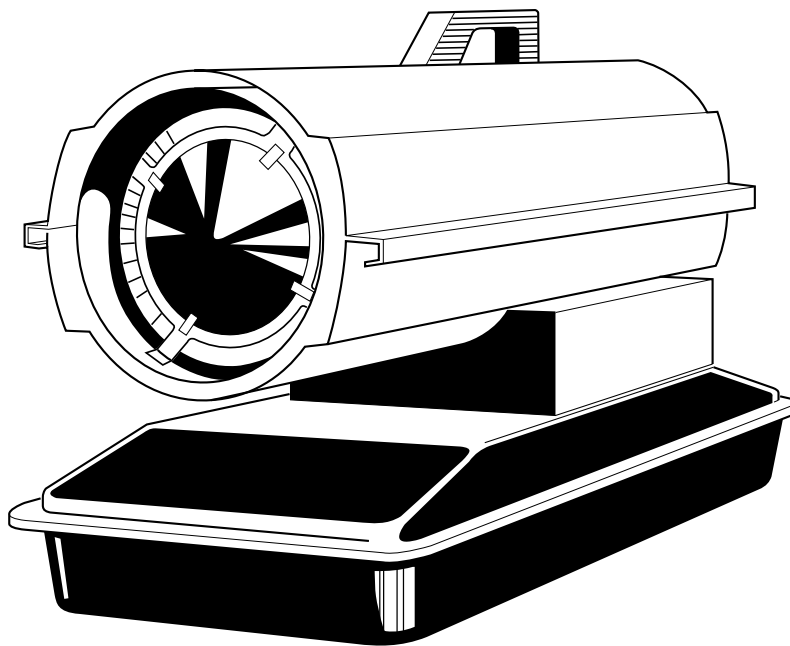

Models HH35A, HH55, HH110 & HH150A

IMPORTANT: Read and understand this manual before assembling, starting, or servicing heater. Improper use of heater can cause serious injury. Keep this manual for future reference.

NOTICE: For Servicing Dealer Information see back page.



Homelite®

PORTABLE SPACE HEATER

SAFETY INFORMATION

WARNINGS

IMPORTANT: Read this Owner's Manual carefully and completely before trying to assemble, operate, or service this heater. Improper use of this heater can cause serious injury or death from burns, fire, explosion, electrical shock, and carbon monoxide poisoning.

 DANGER: Carbon monoxide poisoning may lead to death!

Carbon Monoxide Poisoning: Early signs of carbon monoxide poisoning resemble the flu, with headaches, dizziness, and/or nausea. If you have these signs, the heater may not be working properly. **Get fresh air at once!** Have heater serviced. Some people are more affected by carbon monoxide than others. These include pregnant women, persons with heart or lung disease or anemia, those under the influence of alcohol, and those at high altitudes.

Make certain you read and understand all Warnings. Keep this manual for reference. It is your guide to safe and proper operation of this heater.

- Use only kerosene or No. 1 fuel oil to avoid risk of fire or explosion. Never use gasoline, naphtha, paint thinners, alcohol, or other highly flammable fuels.
- Fueling
 - a) Personnel involved with fueling shall be qualified and thoroughly familiar with the manufacturer's instructions and applicable federal, state, and local regulations regarding the safe fueling of heating units.
 - b) Only the type of fuel specified on the heater's data plate shall be used.
 - c) All flame, including the pilot light, if any, shall be extinguished and the heater allowed to cool, prior to fueling.
 - d) During fueling, all fuel lines and fuel-line connections shall be inspected for leaks. Any leaks shall be repaired prior to returning the heater to service.
 - e) At no time shall more than one day's supply of heater fuel be stored inside a building in the vicinity of the heater. Bulk fuel storage shall be outside the structure.
 - f) All fuel storage shall be located a minimum of 25 feet from heaters, torches, welding equipment, and similar sources of ignition (exception: the fuel reservoir integral with the heater unit).
 - g) Whenever possible, fuel storage shall be confined to areas where floor penetrations do not permit fuel to drip onto or be ignited by a fire at lower elevation.
 - h) Fuel storage shall be in accordance with the federal, state, or local authority having jurisdiction.
- Never use heater where gasoline, paint thinner, or other highly flammable vapors are present.
- Follow all local ordinances and codes when using heater.
- Heaters used in the vicinity of tarpaulins, canvas, or similar enclosure materials shall be located a safe distance from such materials. The recommended minimum safe distance is 10 feet. It is further recommended that these enclosure materials be of a fire retardant nature. These enclosure materials shall be securely fastened to prevent them from igniting or from upsetting the heater due to wind action.
- Use only in well vented areas. Before using heater, provide at least a three-square-foot opening of fresh, outside air for each 100,000 BTU/Hr of rating. This heater produces carbon monoxide, which is listed by the State of California as a reproductive toxin under Proposition 65.
- Use only in places free of flammable vapors or high dust content.
- Use only with the electrical voltage and frequency specified on model plate.
- Use only a three-prong, grounded extension cord.
- Minimum heater clearances from combustibles:

Outlet: 8 Ft.	Sides: 4 Ft.
Top: 4 Ft.	Rear: 4 Ft.
- Locate heater on a stable and level surface while hot or running or a fire may occur.
- When moving or storing heater, keep heater in a level position or fuel spillage may occur.
- Keep children and animals away from heater.
- Unplug heater when not in use.
- When used with thermostat, heater may start at anytime.
- Never use heater in living or sleeping areas.
- Never block air inlet (rear) or air outlet (front) of heater.
- Never move, handle, refuel, or service a hot, operating, or plugged-in heater.
- Never attach duct work to front or rear of heater.

OWNER'S MANUAL

PRODUCT IDENTIFICATION

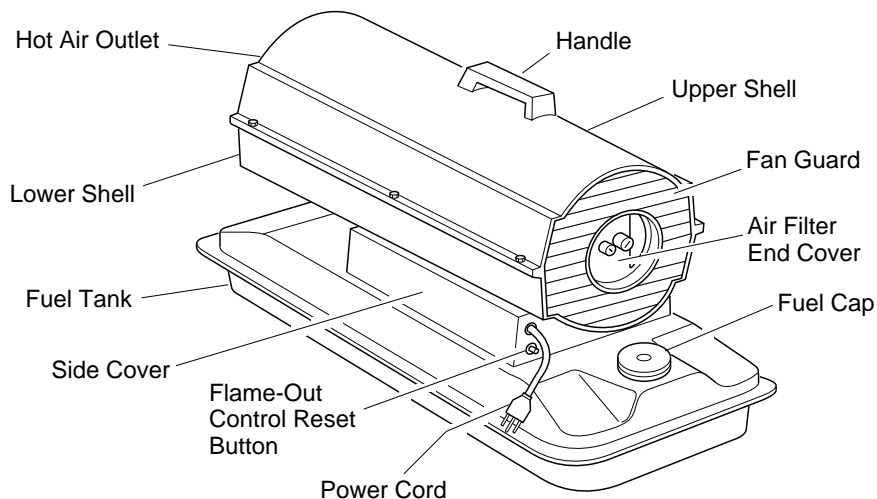

Figure 1 - 35/55,000 BTU/Hr Models

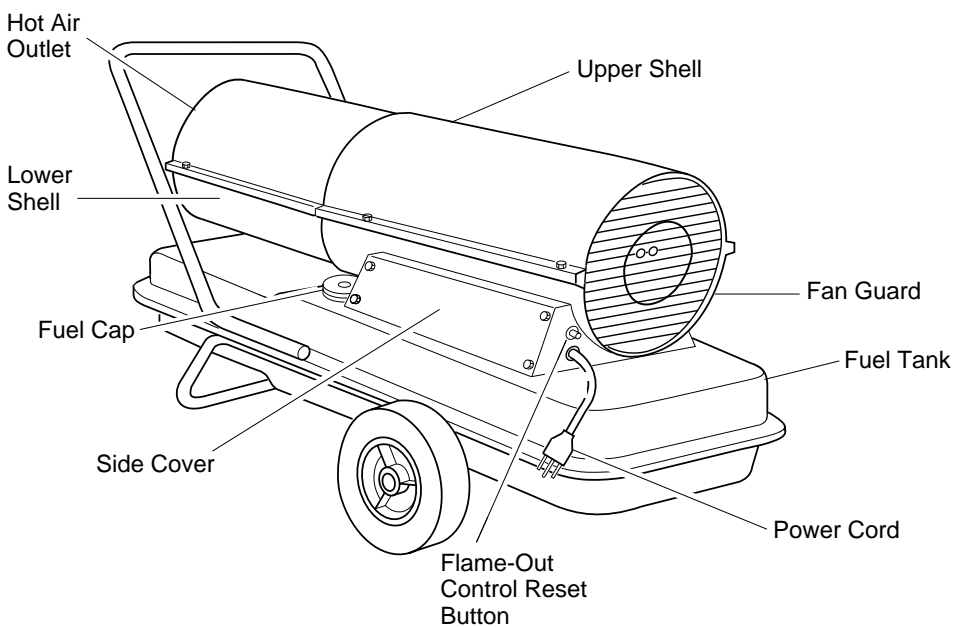

Figure 2 - 110/150,000 BTU/Hr Models

UNPACKING

1. Remove all packing items applied to heater for shipment.
2. Remove all items from carton.
3. Check items for shipping damage. If heater is damaged, promptly inform dealer where you bought heater.

Homelite®

PORTABLE SPACE HEATER

ASSEMBLY

(For 110,000 and 150,000 BTU/Hr Models Only)

These models are furnished with wheels and a front handle. Wheels, handle, and the mounting hardware are found in the shipping carton.

Tools Needed

- Medium Phillips Screwdriver
- 3/8" Open or Adjustable Wrench
- Hammer

1. Slide axle through wheel support frame. Install wheels on axle.

IMPORTANT: When installing wheels, point extended hub of wheels toward wheel support frame (see Figure 3).

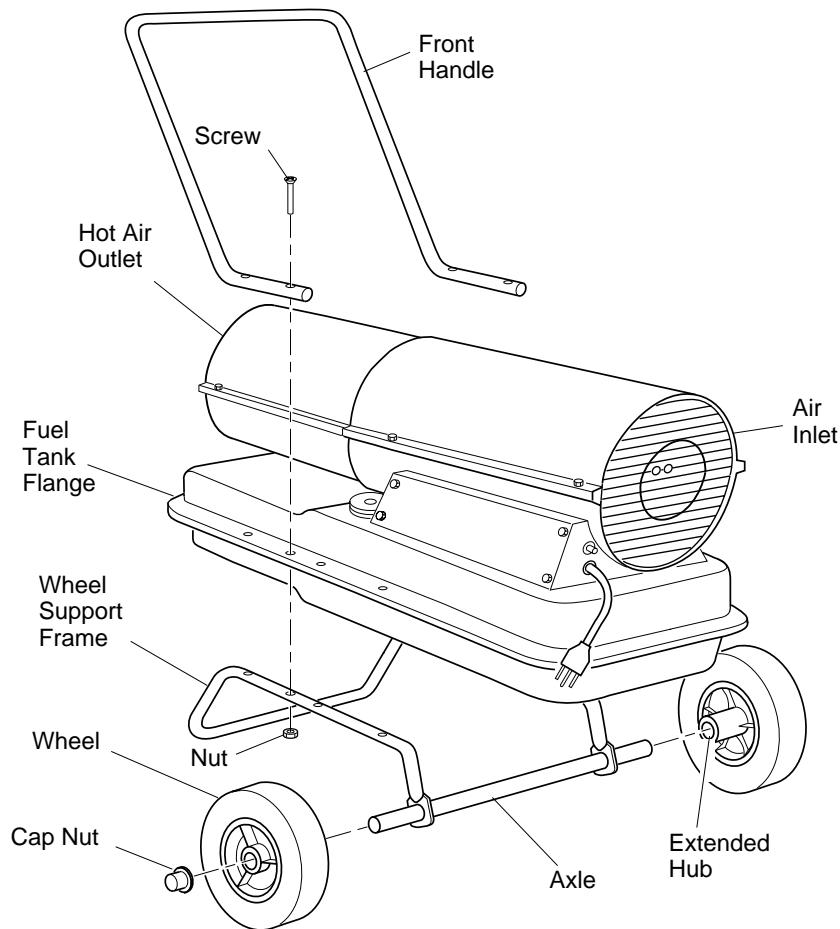

Figure 3 - Wheel and Handle Assembly, 110/150,000 BTU/Hr Models Only

2. Place cap nuts on axle ends. Gently tap with hammer to secure.
3. Place heater on wheel support frame. Make sure air inlet end (rear) of heater is over wheels. Line up holes on fuel tank flange with holes on wheel support frame.
4. Place front handle on top of fuel tank flange. Insert screws through handle(s), fuel tank flange, and wheel support frame. Attach nut finger tight after each screw is inserted.
5. After all screws are inserted, tighten nuts firmly.

FUELS

WARNING: Use only kerosene or No. 1 fuel oil to avoid risk of fire or explosion. Never use gasoline, naphtha, paint thinners, alcohol, or other highly flammable fuels.

Do not use heavy fuels such as No. 2 fuel oil or No. 2 Diesel. Using heavy fuels will result in:

- clogged fuel filter and nozzle
- carbon build-up on spark plug
- the need of non-toxic anti-icer in fuel during very cold weather

IMPORTANT: Use a KEROSENE ONLY storage container. Be sure storage container is clean. Foreign matter such as rust, dirt, or water will cause the flame-out control to shut down heater. Foreign matter may also require you to clean fuel system often.

VENTILATION

WARNING: Follow the minimum fresh, outside air ventilation requirements. If proper fresh, outside air ventilation is not provided, carbon monoxide poisoning can occur. Provide proper fresh, outside air ventilation before running heater.

Provide a fresh air opening of at least three square feet for each 100,000 BTU/Hr rating. Provide extra fresh air if more heaters are being used.

Example: A 150,000 BTU/Hr heater requires one of the following:

- a two-car garage door raised six inches
- a single-car garage door raised nine inches
- two thirty-inch windows raised twelve inches

OWNER'S MANUAL

THEORY OF OPERATION

The Fuel System: The air pump forces air through the air line. The air is then pushed through the burner head nozzle. This air causes fuel to lift from the tank. A fine mist of fuel is sprayed into the combustion chamber.

The Air System: The motor turns the fan. The fan pushes air into and around the combustion chamber. This air is heated and provides a stream of clean, hot air.

The Ignition System: The electronic ignitor sends voltage to the spark plug. The spark plug ignites the fuel and air mixture.

The Flame-Out Control System: This system causes the heater to shut down if the flame goes out.

OPERATION

IMPORTANT: Review and understand the warnings in the *Safety Information* section. They are needed to safely operate this heater. Follow all local codes when using this heater.

To Start Heater

1. Follow all ventilation and safety information.
2. Fill fuel tank with kerosene or No. 1 fuel oil.
3. Attach fuel cap.
4. Plug power cord of heater into three-prong, grounded extension cord. Extension cord must be at least six feet long.

Extension Cord Wire Size Requirements

- 6 to 10 feet long, use 18 AWG rated cord
 - 11 to 100 feet long, use 16 AWG rated cord
 - 101 to 200 feet long, use 14 AWG rated cord
5. Plug extension cord into standard 120 volt/60 hertz, three-hole, grounded outlet. Heater will start when extension cord is plugged into outlet. If not, push in flame-out control reset button (see Figures 5 and 6).

To Stop Heater

Unplug extension cord from outlet.

To Restart Heater

1. Wait 2 minutes after stopping heater.
2. Repeat steps under *To Start Heater*.

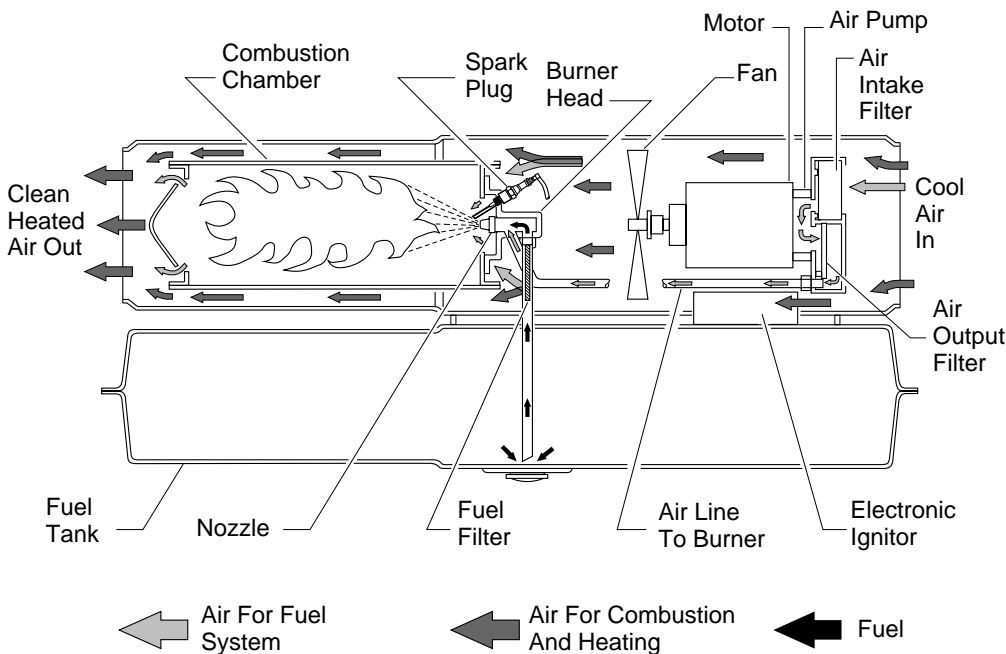

Figure 4 - Cross Section Operational View

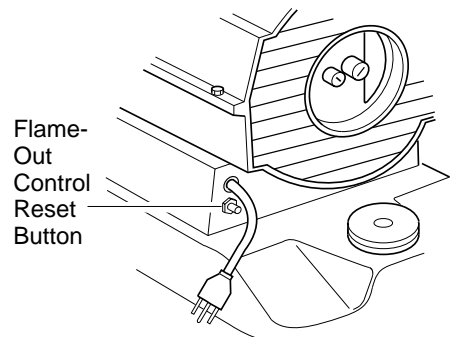

Figure 5 - Flame-Out Control Reset Button, 35/55,000 BTU/Hr Models

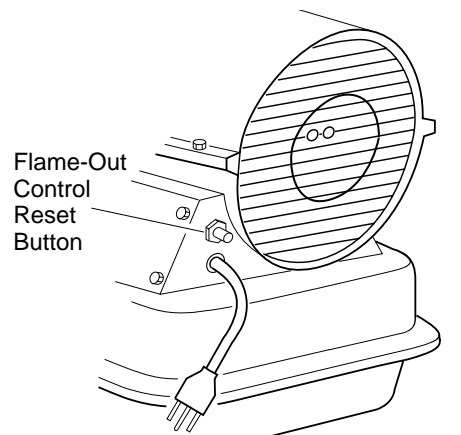

Figure 6 - Flame-Out Control Reset Button, 110/150,000 BTU/Hr Models

Homelite®

PORTABLE SPACE HEATER

STORING, TRANSPORTING, OR SHIPPING

Note: If shipping, transport companies require fuel tanks to be empty.

1. Drain fuel tank.

Note: Some models have drain plug on underside of fuel tank. If so, remove drain plug to drain all fuel. If heater does not have drain plug, drain fuel through fuel cap opening. Be sure all fuel is removed.

2. Replace drain plug if provided.
3. If any debris is noted in old fuel, add 1 or 2 quarts of clean kerosene to tank, stir, and drain again. This will prevent excess debris from clogging filters during future use.
4. Replace fuel cap or drain plug. Properly dispose of old and dirty fuel. Check with local automotive service stations that recycle oil.
5. If storing, store heater in dry place. Make sure storage place is free of dust and corrosive fumes.

IMPORTANT: Do not store kerosene over summer months for use during next heating season. Using old fuel could damage heater.

PREVENTATIVE MAINTENANCE SCHEDULE

Item	How Often	How To
Fuel tank	Flush every 150-200 hours of operation or as needed.	See <i>Storing, Transporting, or Shipping</i> , column 1.
Air output and lint filters	Replace every 500 hours of operation or once a year.	See <i>Air Output, Air Intake, and Lint Filters</i> , page 8.
Air intake filter	Wash and dry with soap and water every 500 hours of operation or replace as needed.	See <i>Air Output, Air Intake, and Lint Filters</i> , page 8
Fuel filter	Clean twice a heating season or replace as needed.	See <i>Fuel Filter</i> , page 9
Spark plug	Clean and regap every 600 hours operation or replace as needed.	See <i>Spark Plug</i> , page 10
Fan blades	Clean each season or as needed	See <i>Fan</i> , page 8.
Motor	Not required/permanently lubricated	

⚠ WARNING: Never service heater while it is plugged in, operating, or hot. Severe burns and electrical shock can occur.

OWNER'S MANUAL

TROUBLESHOOTING

 **WARNING: Never service heater while it is plugged in, operating, or hot. Severe burns and electrical shock can occur.**

OBSERVED FAULT

POSSIBLE CAUSE

REMEDY

Heater ignites, but flame-out control shuts off heater after a short period of time.

1. Wrong pump pressure
2. Dirty air output, air intake and lint filters
3. Dirty fuel filter
4. Dirt in nozzle
5. Dirty photocell lens
6. Bad flame-out control

1. See *Pump Pressure Adjustment*, page 9
2. See *Air Output, Air Intake and Lint Filters*, page 8
3. See *Fuel Filter*, page 9
4. See *Nozzle*, page 11
5. Clean photocell lens
6. Replace flame-out control

 **WARNING: Disconnect heater cord!**

Heater will not ignite, but motor runs for a short period of time.

1. Wrong pump pressure.
2. Carbon deposits on spark plug and/or improper gap
3. Dirty fuel filter
4. Dirt in nozzle
5. Water in fuel tank

1. See *Pump Pressure Adjustment*, page 9
2. See *Spark Plug*, page 10
3. See *Fuel Filter*, page 9
4. See *Nozzle*, page 11
5. Drain and flush fuel tank with clean kerosene. See *Storing, Transporting, or Shipping*, page 6.

 **WARNING: High Voltage!**

6. Electronic ignitor not grounded
7. Bad electronic ignitor

6. Make sure electronic ignitor mounting is tight.
7. Replace electronic ignitor.

Motor does not start when heater is plugged in, fan rotates slowly or does not turn.

1. Flame-out control not reset
2. Solid state relay not allowed to reset
3. Binding pump rotor

1. Press flame-out control reset button.
2. Wait two minutes before trying to restart heater.
3. If fan is hard to turn, see *Pump Rotor*, page 12.

Homelite®

PORTABLE SPACE HEATER

SERVICE PROCEDURES

⚠ WARNING: Never service heater while it is plugged in, operating, or hot. Severe burns and electrical shock can occur.

UPPER SHELL REMOVAL

1. Remove screws along each side of heater using 5/16" nut-driver. These screws attach upper and lower shells together.
2. Lift upper shell off.
3. Remove fan guard.

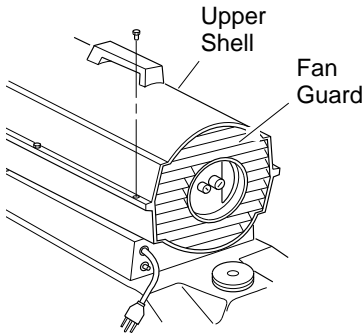

Figure 7 - Upper Shell Removal, 35/55,000 BTU/Hr Models

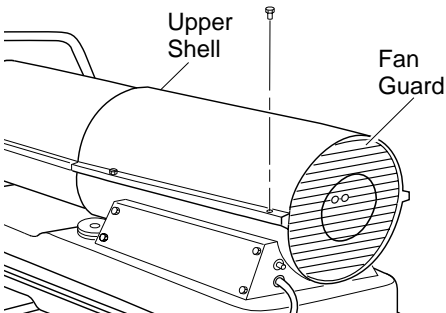

Figure 8 - Upper Shell Removal, 110/150,000 BTU/Hr Models

FAN

IMPORTANT: Remove fan from motor shaft before removing motor from heater. The weight of the motor resting on the fan could damage the fan pitch.

1. Remove upper shell (see *Upper Shell Removal*).
2. Use 1/8" allen wrench to loosen set-screw which holds fan to motor shaft.
3. Slip fan off motor shaft.
4. Clean fan using soft cloth moistened with kerosene or solvent.
5. Dry fan thoroughly.
6. (35/55/110,000 BTU/Hr Models) Replace fan on motor shaft. Place fan hub flush with end of motor shaft (see Figure 9). (150,000 BTU/Hr Model) Replace fan on motor shaft. Make sure set screw is touching back of flat surface on motor shaft (see Figure 10).
7. Place setscrew on flat of shaft. Tighten setscrew firmly (40-50 inch-pounds).
8. Replace fan guard and upper shell.

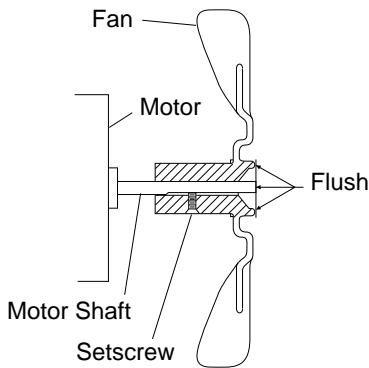

Figure 9 - Fan Cross Section 35/55/110,000 BTU/Hr Models

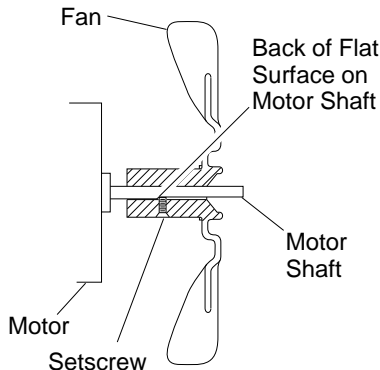

Figure 10 - Fan Cross Section 150,000 BTU/Hr Model

AIR OUTPUT, AIR INTAKE, AND LINT FILTERS

1. Remove upper shell (see *Upper Shell Removal*).
2. Remove filter end cover screws using 5/16" nut-driver.
3. Remove filter end cover.
4. Replace air output and lint filters.
5. Wash or replace air intake filter (see *Preventative Maintenance Schedule*, page 6).
6. Replace filter end cover.
7. Replace fan guard and upper shell.

IMPORTANT: Do not oil filters.

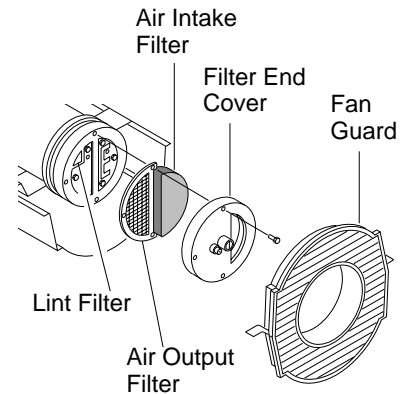

Figure 11 - Air Output, Air Intake, and Lint Filters, 35/55,000 BTU/Hr Models

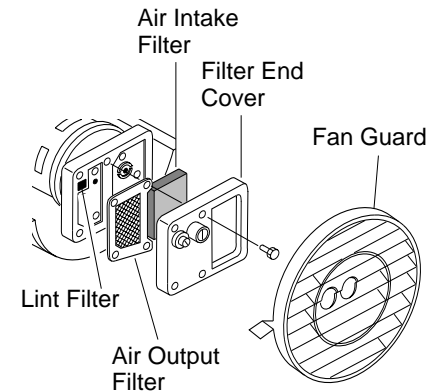

Figure 12 - Air Output, Air Intake, and Lint Filters, 110/150,000 BTU/Hr Models

SERVICE PROCEDURES

Continued

PUMP PRESSURE ADJUSTMENT

1. Remove pressure gauge plug from filter end cover.
2. Install accessory pressure gauge (part number 00529-02).
3. Start heater (see *Operation*, page 5). Allow motor to reach full speed.
4. Adjust pressure. Turn relief valve to right to increase pressure. Turn relief valve to left to decrease pressure. Set pump pressure as follows:

35,000 Btu/Hr Model	3.0 PSI
55,000 Btu/Hr Model	3.4 PSI
110,000 Btu/Hr Model	4.5 PSI
150,000 Btu/Hr Model	5.0 PSI
5. Remove pressure gauge. Replace pressure gauge plug in filter end cover.

(35/55,000 BTU/Hr Models Shown)

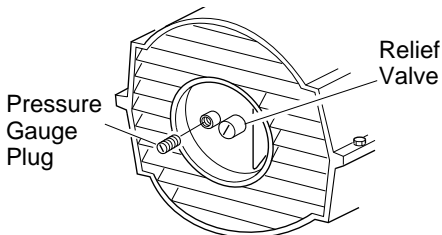

Figure 13 - Pressure Gauge Plug Removal

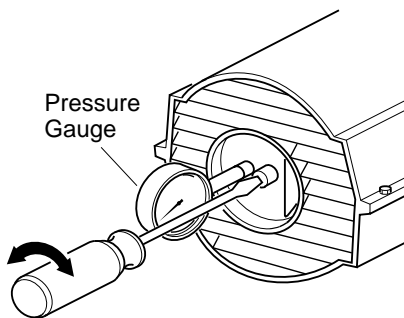

Figure 14 - Adjusting Pump Pressure

FUEL FILTER (35/55/110/150,000 BTU/Hr Models)

1. Remove side cover screws using 5/16" nut-driver.
2. Remove side cover.
3. Pull upper fuel line off fuel filter neck.
4. Carefully pry bushing, fuel filter, and lower fuel line (110/150,000 BTU/Hr models only) out of fuel tank.
5. Wash fuel filter with clean fuel and replace in tank.
6. Attach upper fuel line to fuel filter neck.
7. Replace side cover.

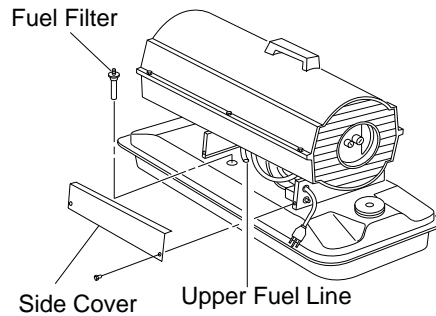

Figure 15 - Fuel Filter Removal, 35/55,000 BTU/Hr Models

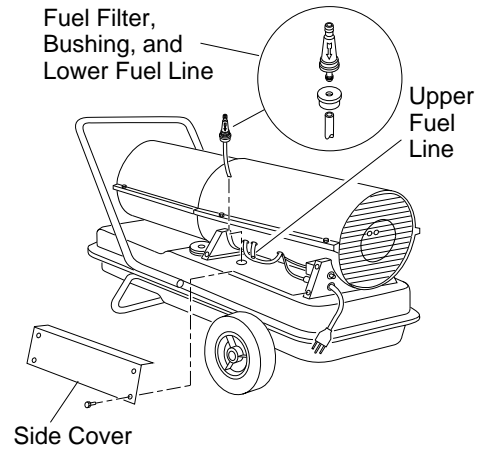

Figure 16 - Fuel Filter Removal, 110/150,000 BTU/Hr Models

Continued

PORTABLE SPACE HEATER

SERVICE PROCEDURES *Continued*

SPARK PLUG (35/55,000 BTU/Hr Models)

1. Remove upper shell (see *Upper Shell Removal*, page 8).
2. Remove fan (see *Fan*, page 8).
3. Remove fuel and air line hoses from nozzle assembly.
4. Remove spark plug wire from spark plug.
5. Remove two (2) screws using 5/16" nut-driver and remove burner strap.
6. Place hex-body of spark plug into vise and tighten.
7. Remove spark plug mounting nut using 11/16" open-end wrench.
8. Remove burner strap from spark plug.
9. Clean and regap spark plug electrodes to .055" gap for 35,000 Btu/Hr model and .075" gap for 55,000 Btu/Hr model.
10. Replace burner strap onto spark plug. Rotate burner strap to position spark plug electrodes (see Figure 19).
11. Tighten spark plug with spark plug mounting nut.
12. Release hex-body of spark plug from vise.
13. Replace burner strap onto combustion chamber.
14. Attach spark plug wire to spark plug.
15. Attach fuel and air line hoses to nozzle assembly.
16. Replace fan (see *Fan*, page 8).
17. Replace fan guard and upper shell.

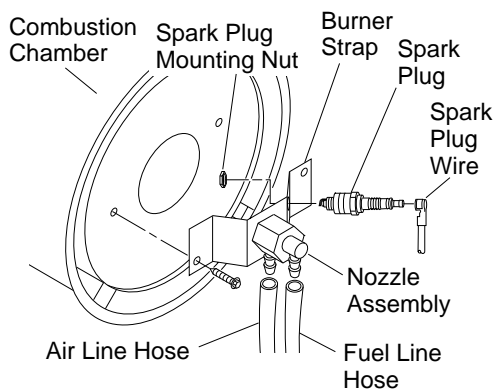

Figure 17 - Spark Plug Removal, 35/55,000 BTU/Hr Models

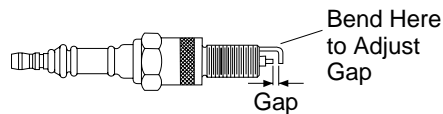

Figure 18 - Spark Plug Gap, 35/55,000 BTU/Hr Models

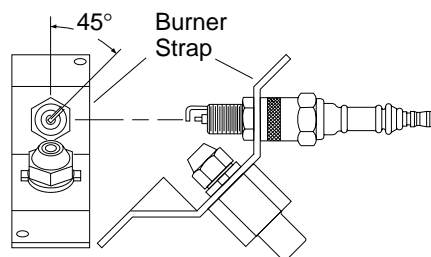

Figure 19 - Spark Plug Rotation, 35/55,000 BTU/Hr Models Only

Spark Plug (110/150,000 BTU/Hr Models)

1. Remove upper shell (see *Upper Shell Removal*, page 8).
2. Remove fan (see *Fan*, page 8).
3. Remove spark plug wire from spark plug.
4. Remove spark plug from burner head using 13/16" open-end wrench.
5. Clean and regap spark plug electrodes to .075" gap.
6. Install spark plug in burner head.
7. Attach spark plug wire to spark plug.
8. Replace fan (see *Fan*, page 8).
9. Replace fan guard and upper shell.

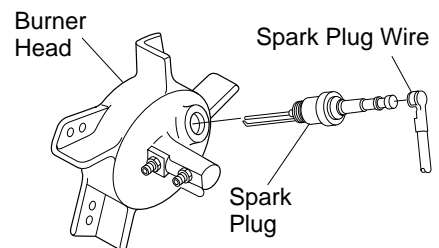

Figure 20 - Spark Plug Removal, 110/150,000 BTU/Hr Models

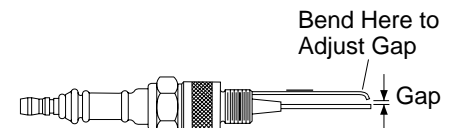

Figure 21 - Spark Plug Gap, 110/150,000 BTU/Hr Models

SERVICE PROCEDURES

Continued

NOZZLE

(35/55,000 BTU/Hr Models)

1. Remove upper shell (see *Upper Shell Removal*, page 8).
2. Remove fan (see *Fan*, page 8).
3. Remove fuel and air line hoses from nozzle assembly.
4. Turn nozzle assembly 1/4 turn to left and pull toward motor to remove.
5. Place plastic hex-body into vise and lightly tighten.
6. Carefully remove nozzle from the nozzle adapter using 5/8" socket wrench.
7. Blow compressed air through face of nozzle. This will free any dirt in nozzle area.
8. Inspect nozzle sleeve for damage.

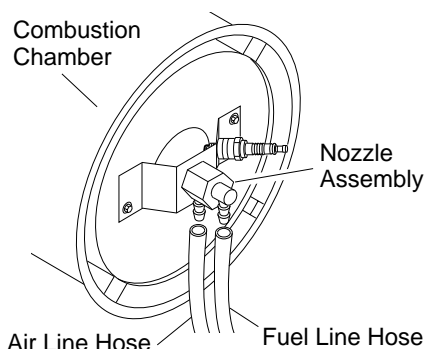

Figure 22 - Removing Air and Fuel Line Hoses, 35/55,000 BTU/Hr Models

9. Replace nozzle into nozzle adapter until nozzle seats. Tighten 1/3 turn more using 5/8" socket wrench (40-45 inch-pounds).
10. Attach nozzle assembly to burner strap.
11. Attach fuel and airline hoses to nozzle assembly.
12. Replace fan (see *Fan*, page 8).
13. Replace fan guard and upper shell.

NOZZLE

(110/150,000 BTU/Hr Models)

1. Remove upper shell (see *Upper Shell Removal*, page 8).
2. Remove fan (see *Fan*, page 8).
3. Remove fuel and air line hoses from burner head.
4. Remove spark plug wire from spark plug.
5. Remove spark plug from burner head using 13/16" open-end wrench.

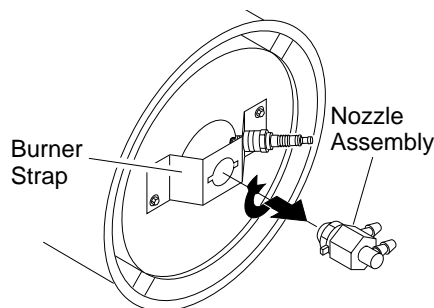

Figure 23 - Removing Nozzle Assembly, 35/55,000 BTU/Hr Models

6. Remove three screws using 5/16" nut-driver and remove burner head from combustion chamber.
7. Place burner head into vise and lightly tighten.
8. Carefully remove nozzle from burner head using 5/8" socket wrench (see Figure 26, page 12).
9. Blow compressed air through face of nozzle. This will free any dirt in nozzle area.
10. Inspect nozzle sleeve for damage.
11. Replace nozzle into burner head and tighten firmly (80-110 inch-pounds).
12. Attach burner head to combustion chamber.
13. Install spark plug in burner head.
14. Attach spark plug wire to spark plug.
15. Attach fuel and airline hoses to burner head.
16. Replace fan (see *Fan*, page 8).
17. Replace fan guard and upper shell.

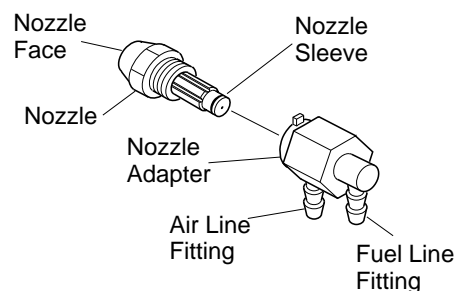

Figure 24 - Nozzle and Nozzle Adapter, 35/55,000 BTU/Hr Models

Homelite®

PORTABLE SPACE HEATER

SERVICE PROCEDURES

Continued

PUMP ROTOR (Procedure if rotor is binding)

1. Remove upper shell (see *Upper Shell Removal*, page 8).
2. Remove filter end cover screws using 5/16" nut-driver.
3. Remove filter end cover and air filters.
4. Remove pump plate screws using 5/16" nut-driver.

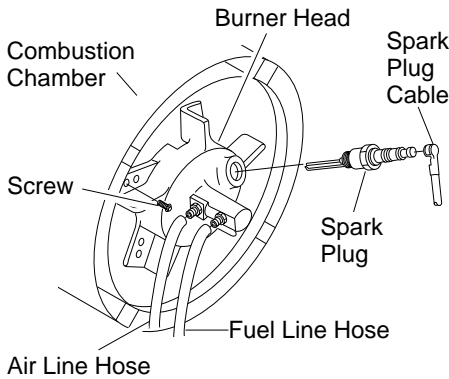

Figure 25 - Removing Burner Head, 110/150,000 BTU/Hr Models

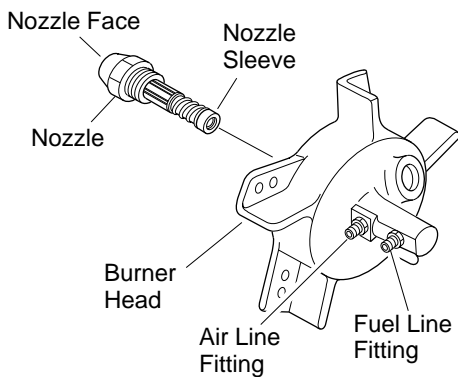

Figure 26 - Removing Nozzle, 110/150,000 BTU/Hr Models

5. Remove pump plate.
6. Remove rotor, insert, and blades.
7. Check for debris in pump. If debris is found, blow out with compressed air.
8. Install insert and rotor.
9. Check gap on rotor. Adjust to .003"/.004" if needed (see Figure 29).
Note: Rotate rotor one full turn to insure the gap is .003"/.004" at tightest position. Adjust if needed.
10. Install blades, pump plate, air filters, and filter end cover.

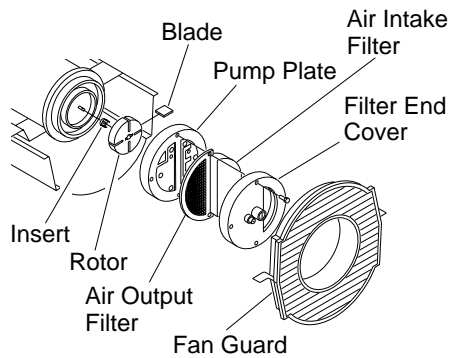

Figure 27 - Rotor Location, 35/55,000 BTU/Hr Models

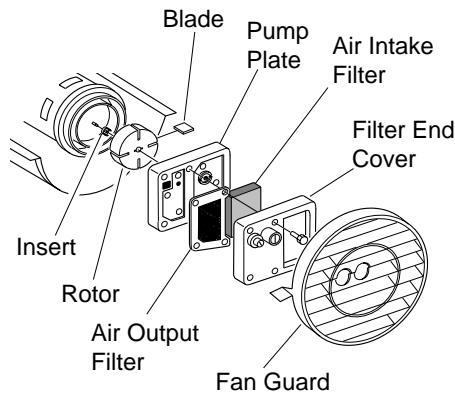

Figure 28 - Rotor Location, 110/150,000 BTU/Hr Models

11. Replace fan guard and upper shell.
12. Adjust pump pressure (see page 10).
Note: If rotor is still binding, proceed as follows.
13. Perform steps 1 through 6.
14. Place fine grade sandpaper (600 grit) on flat surface. Sand rotor lightly in "figure 8" motion four times (see Figure 30).
15. Reinstall insert and rotor.
16. Perform steps 10 through 12 above.

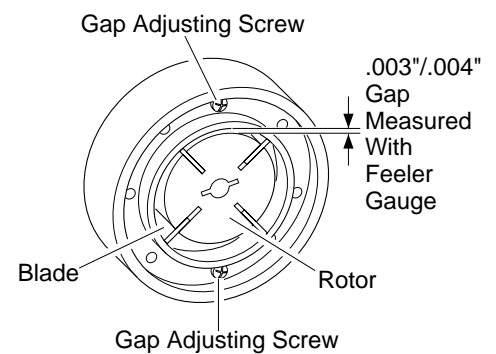

Figure 29 - Gap Adjusting Screw Locations

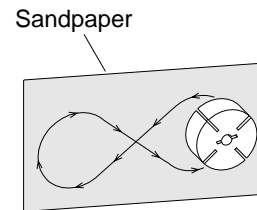

Figure 30 - Sanding Rotor

OWNER'S MANUAL

SPECIFICATIONS

Output Rating (BTU/Hr.)	35,000	55,000	110,000	150,000
Fuel	Use Only Kerosene or No. 1 Fuel Oil			
Fuel Tank Capacity (U.S. Gal.)	3.0	5.0	9.0	13.5
Fuel Consumption (Gal. Per Hr.)	.26	.40	.82	1.10
Electric Requirements	120 V/60 Hz (Same All Models)			
Amperage (Normal Run)	2.0	2.0	4.5	4.5
Hot Air Output (CFM)	165	175	490	500

WIRING DIAGRAMS

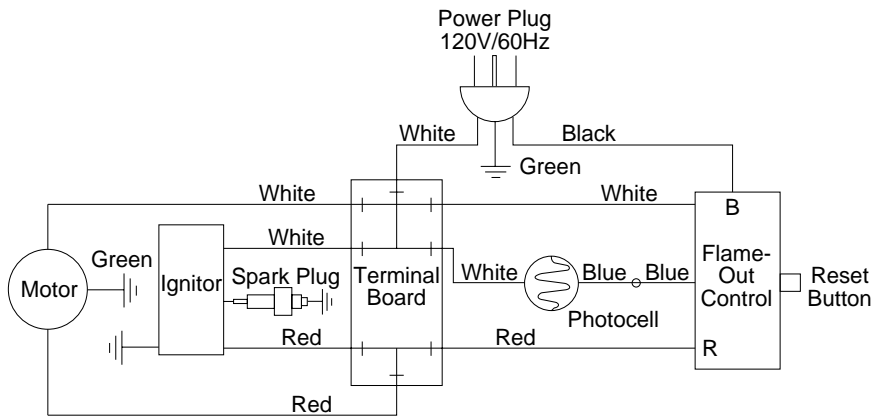

Figure 31 - Wiring Diagram, 35/55,000 BTU/Hr Models

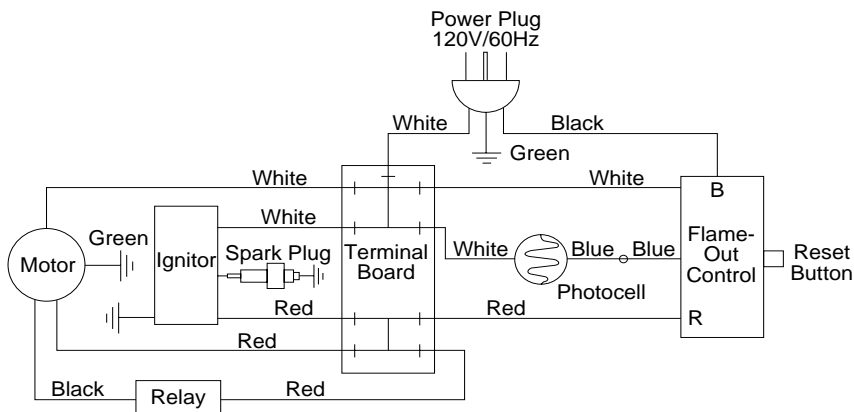

Figure 32 - Wiring Diagram, 110/150,000 BTU/Hr Models

Homelite®

PORTABLE SPACE HEATER

ACCESSORIES

Purchase accessories and parts from your nearest dealer.

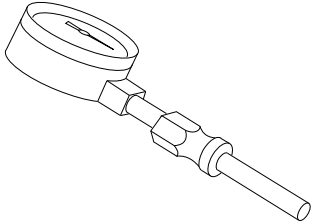

AIR GAUGE KIT - 00529-02

For all models. Special tool to check pump pressure.

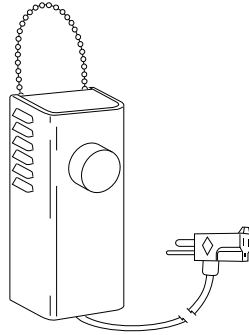

THERMOSTAT KIT - 00529-03

For all models. Keeps your building at the temperature you select day and night. Helps economize on fuel.

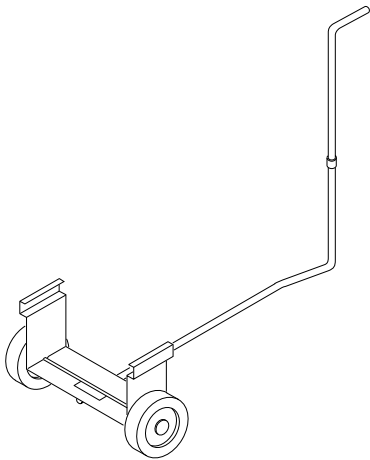

STANDARD WHEELS AND HANDLE KIT - 00529-05

Makes heater even more portable and convenient. Easy to assemble. Fits 35/55,000 BTU/Hr models.

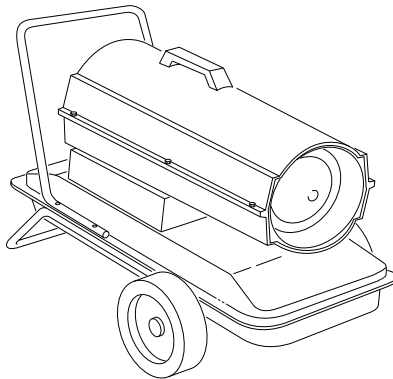

HEAVY DUTY WHEELS AND HANDLE KIT - 00529-04

For heavy duty applications. Makes your heater even more portable and convenient. Fits 35/55,000 BTU/Hr models.

CUSTOMER ASSISTANCE

For the location of your nearest Homelite servicing dealer in the United States, Puerto Rico, and the Virgin Islands

CALL: 1-800-242-4672

NOTE: Dealer information, technical advice, and product information can be obtained at this number.

HEADQUARTERS

HOMELITE
P.O. BOX 7047
CHARLOTTE, N.C. 28241

OVERSEAS OFFICES

ENGLAND

HOMELITE
UNIT 22
Hither Green Trading Estate
Clevedon (Nr. Bristol)
Avon, BS 21 6XU England

FRANCE

HOMELITE
S.A.R.L.
Z.I. du Vert-Galant
Rue du Chateau/Rue de la Garenne
95310 Saint-Quen-L'Aumone
France

NETHERLANDS

HOMELITE
(HDQS. — Europe, Africa and Middle East)
Haverstraat 24
2153 GB Nieuw Vennepe
The Netherlands

AUSTRALIA

HOMELITE
HEADQUARTERS
22 Terra-Cotta Drive
Blackburn, 3130
Victoria, Australia

CANADIAN OFFICES

HOMELITE

1850 55th Avenue
Lachine, Quebec, Canada
H8T 3J5

212-214 590 Ebury Place
Annacis Island
Delta, British Columbia
V3M 6K7

595 Canarctic Drive
Downsview (Toronto)
Ontario, Canada
M3J 2P9

16520-111th Avenue
Edmonton, Alberta
T5M 3V8

691 Malenfant Blvd.
Dieppe Industrial Park
Dieppe, New Brunswick
E1A 5T8

Homelite.inc.

A Subsidiary of Deere & Company



100507 01

NOT A UPC

100507-01
REV. E
08/98